

## Derde verdieping

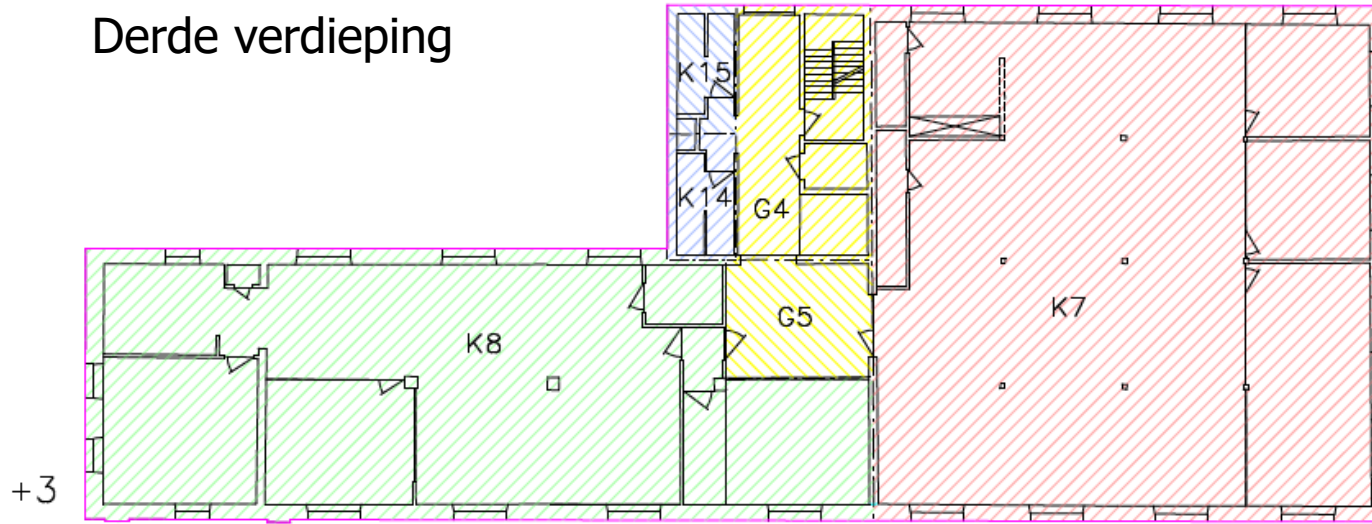

## Parking

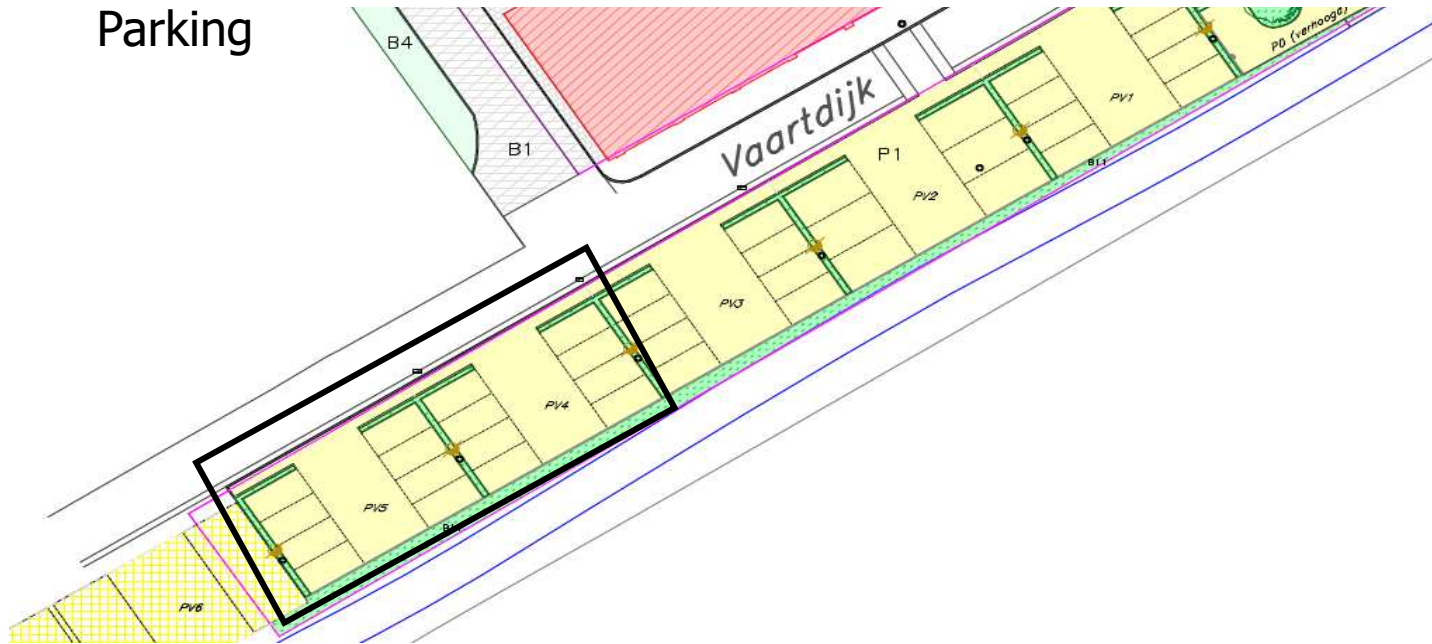

## Opslagruimte

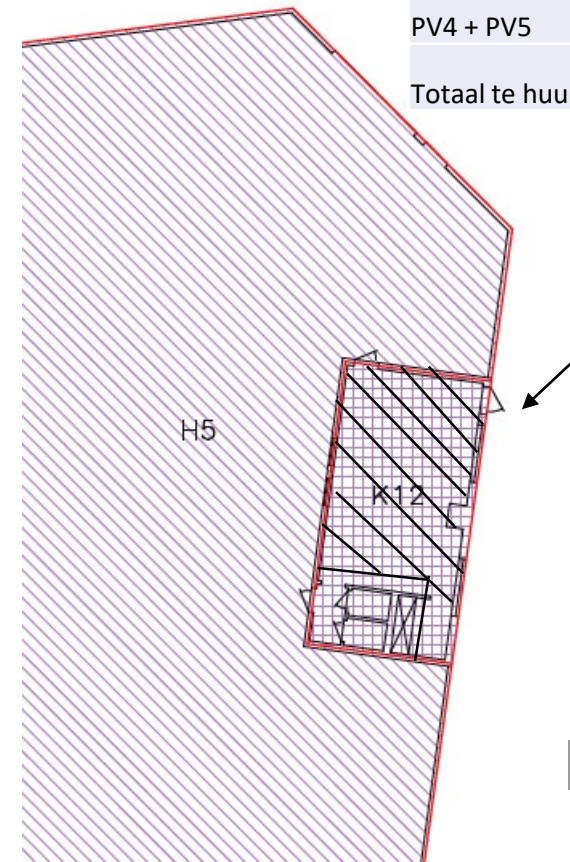

Deel	Opp.
K15	10,00m <sup>2</sup>
K14	9,68m <sup>2</sup>
G4	38,61m <sup>2</sup>
G5	19,37m <sup>2</sup>
K7	296,60m <sup>2</sup>
K8	217,95m <sup>2</sup>
K12	46,22m <sup>2</sup>
PV4 + PV5	20 parkeerplaatsen
<b>Totaal te huur</b>	<b>638,43m<sup>2</sup></b>